

MASCHI A MANO

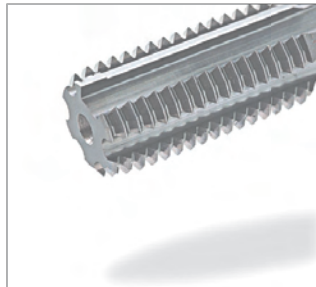

3.119.710

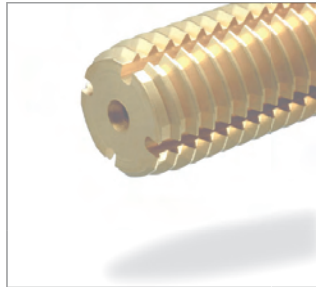
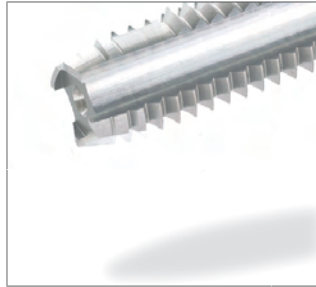
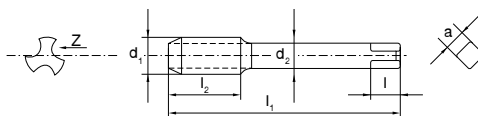

d₁	P	Tipo	l₁	l₂	d₂	l	a	z	Codice	€
M1.4	0.30	No.1	32	7	2.5	5	2.1	3	910.020-I	15,30
M1.4	0.30	No.2	32	7	2.5	5	2.1	3	910.020-II	15,30
M1.4	0.30	No.3	32	7	2.5	5	2.1	3	910.020-III	15,30
M1.4	0.30	Serie	32	7	2.5	5	2.1	3	910.020-S	45,80
M1.6	0.35	No.1	32	8	2.5	5	2.1	3	910.025-I	13,56
M1.6	0.35	No.2	32	8	2.5	5	2.1	3	910.025-II	13,56
M1.6	0.35	No.3	32	8	2.5	5	2.1	3	910.025-III	13,56
M1.6	0.35	Serie	32	8	2.5	5	2.1	3	910.025-S	40,70
M1.7	0.35	No.1	32	8	2.5	5	2.1	3	910.030-I	14,33
M1.7	0.35	No.2	32	8	2.5	5	2.1	3	910.030-II	14,33
M1.7	0.35	No.3	32	8	2.5	5	2.1	3	910.030-III	14,33
M1.7	0.35	Serie	32	8	2.5	5	2.1	3	910.030-S	43,00
M1.8	0.35	No.1	32	8	2.5	5	2.1	3	910.035-I	13,56
M1.8	0.35	No.2	32	8	2.5	5	2.1	3	910.035-II	13,56
M1.8	0.35	No.3	32	8	2.5	5	2.1	3	910.035-III	13,56
M1.8	0.35	Serie	32	8	2.5	5	2.1	3	910.035-S	40,70
M2	0.40	No.1	36	8	2.8	5	2.1	3	910.040-I	11,57
M2	0.40	No.2	36	8	2.8	5	2.1	3	910.040-II	11,57
M2	0.40	No.3	36	8	2.8	5	2.1	3	910.040-III	11,57
M2	0.40	Serie	36	8	2.8	5	2.1	3	910.040-S	34,75
M2.2	0.45	No.1	36	9	2.8	5	2.1	3	910.045-I	13,22
M2.2	0.45	No.2	36	9	2.8	5	2.1	3	910.045-II	13,22
M2.2	0.45	No.3	36	9	2.8	5	2.1	3	910.045-III	13,22
M2.2	0.45	Serie	36	9	2.8	5	2.1	3	910.045-S	39,70
M2.3	0.40	No.1	36	9	2.8	5	2.1	3	910.050-I	13,56
M2.3	0.40	No.2	36	9	2.8	5	2.1	3	910.050-II	13,56
M2.3	0.40	No.3	36	9	2.8	5	2.1	3	910.050-III	13,56
M2.3	0.40	Serie	36	9	2.8	5	2.1	3	910.050-S	40,70
M2.5	0.45	No.1	40	9	2.8	5	2.1	3	910.055-I	10,03
M2.5	0.45	No.2	40	9	2.8	5	2.1	3	910.055-II	10,03
M2.5	0.45	No.3	40	9	2.8	5	2.1	3	910.055-III	10,03
M2.5	0.45	Serie	40	9	2.8	5	2.1	3	910.055-S	30,10
M2.6	0.45	No.1	40	9	2.8	5	2.1	3	910.060-I	10,92
M2.6	0.45	No.2	40	9	2.8	5	2.1	3	910.060-II	10,92
M2.6	0.45	No.3	40	9	2.8	5	2.1	3	910.060-III	10,92
M2.6	0.45	Serie	40	9	2.8	5	2.1	3	910.060-S	32,80

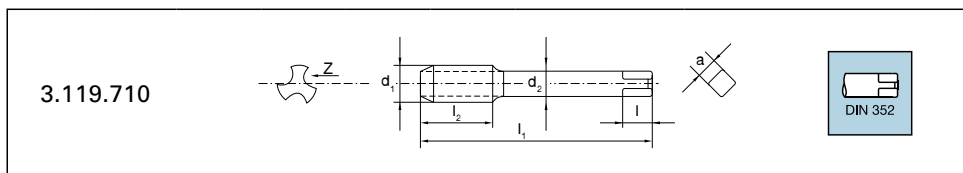

d_1	P	Tipo	l_1	l_2	d_2	l	a	z	Codice	€
M9	1.25	No.1	63	22	7.0	8	5.5	4	910.105-I	15,50
M9	1.25	No.2	63	22	7.0	8	5.5	4	910.105-II	15,50
M9	1.25	No.3	63	22	7.0	8	5.5	4	910.105-III	15,50
M9	1.25	Serie	63	22	7.0	8	5.5	4	910.105-S	46,50
M10	1.50	No.1	70	24	7.0	8	5.5	4	910.110-I	11,95
M10	1.50	No.2	70	24	7.0	8	5.5	4	910.110-II	11,95
M10	1.50	No.3	70	24	7.0	8	5.5	4	910.110-III	11,95
M10	1.50	Serie	70	24	7.0	8	5.5	4	910.110-S	35,85
M11	1.50	No.1	70	24	8.0	9	6.2	4	910.115-I	20,50
M11	1.50	No.2	70	24	8.0	9	6.2	4	910.115-II	20,50
M11	1.50	No.3	70	24	8.0	9	6.2	4	910.115-III	20,50
M11	1.50	Serie	70	24	8.0	9	6.2	4	910.115-S	61,50
M12	1.75	No.1	75	28	9.0	10	7	4	910.120-I	15,70
M12	1.75	No.2	75	28	9.0	10	7	4	910.120-II	15,70
M12	1.75	No.3	75	28	9.0	10	7	4	910.120-III	15,70
M12	1.75	Serie	75	28	9.0	10	7	4	910.120-S	47,10
M14	2.00	No.1	80	30	11.0	12	9	4	910.125-I	20,45
M14	2.00	No.2	80	30	11.0	12	9	4	910.125-II	20,45
M14	2.00	No.3	80	30	11.0	12	9	4	910.125-III	20,45
M14	2.00	Serie	80	30	11.0	12	9	4	910.125-S	61,40
M16	2.00	No.1	80	32	12.0	12	9	4	910.130-I	24,60
M16	2.00	No.2	80	32	12.0	12	9	4	910.130-II	24,60
M16	2.00	No.3	80	32	12.0	12	9	4	910.130-III	24,60
M16	2.00	Serie	80	32	12.0	12	9	4	910.130-S	73,70
M18	2.50	No.1	95	34	14.0	14	11	4	910.135-I	35,85
M18	2.50	No.2	95	34	14.0	14	11	4	910.135-II	35,85
M18	2.50	No.3	95	34	14.0	14	11	4	910.135-III	35,85
M18	2.50	Serie	95	34	14.0	14	11	4	910.135-S	107,50
M20	2.50	No.1	95	34	16.0	15	12	4	910.140-I	36,85
M20	2.50	No.2	95	34	16.0	15	12	4	910.140-II	36,85
M20	2.50	No.3	95	34	16.0	15	12	4	910.140-III	36,85
M20	2.50	Serie	95	34	16.0	15	12	4	910.140-S	110,50
M22	2.50	No.1	100	34	18.0	17	14.5	4	910.145-I	43,90
M22	2.50	No.2	100	34	18.0	17	14.5	4	910.145-II	43,90
M22	2.50	No.3	100	34	18.0	17	14.5	4	910.145-III	43,90
M22	2.50	Serie	100	34	18.0	17	14.5	4	910.145-S	131,50

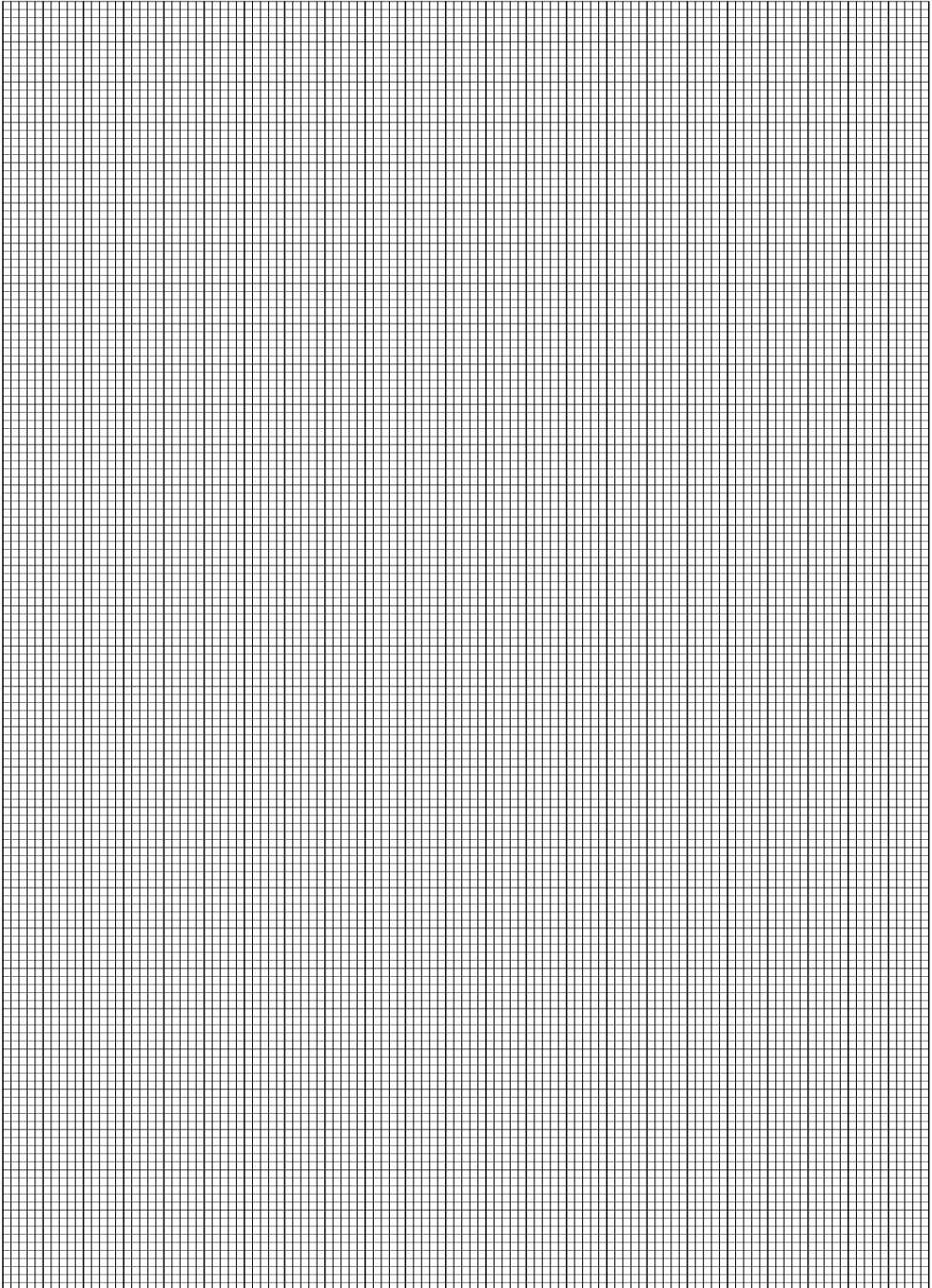

No. 1		 FORMA A - 6-8 -xP	Acciaio ≤ 500 N/mm ²	Acciaio 500-800 N/mm ²
			ALU Si <10%	CU
No. 2		 FORMA D - 3,5-5 -xP		
No. 3		 FORMA C - 2-3 -xP	ISO2 (6H)	

MASCHI A MANO



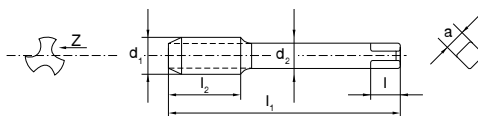

M	 60° -P-	LH	 0°	HSS	
	 >2xd		 SECCO	 EMULSIONE	 OLIO

3.119.710-LH



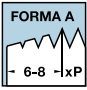



d ₁	P	Tipo	l ₁	l ₂	d ₂	l	a	z	Codice	€
M3	0.50	No.1	40	11	3.5	6	2.7	3	915.065-I	17,65
M3	0.50	No.2	40	11	3.5	6	2.7	3	915.065-II	17,65
M3	0.50	No.3	40	11	3.5	6	2.7	3	915.065-III	17,65
M3	0.50	Serie	40	11	3.5	6	2.7	3	915.065-S	53,00
M4	0.70	No.1	45	13	4.5	6	3.4	3	915.075-I	18,00
M4	0.70	No.2	45	13	4.5	6	3.4	3	915.075-II	18,00
M4	0.70	No.3	45	13	4.5	6	3.4	3	915.075-III	18,00
M4	0.70	Serie	45	13	4.5	6	3.4	3	915.075-S	54,00
M5	0.80	No.1	50	16	6.0	8	4.9	3	915.085-I	18,00
M5	0.80	No.2	50	16	6.0	8	4.9	3	915.085-II	18,00
M5	0.80	No.3	50	16	6.0	8	4.9	3	915.085-III	18,00
M5	0.80	Serie	50	16	6.0	8	4.9	3	915.085-S	54,00
M6	1.00	No.1	56	19	6.0	8	4.9	3	915.090-I	18,75
M6	1.00	No.2	56	19	6.0	8	4.9	3	915.090-II	18,75
M6	1.00	No.3	56	19	6.0	8	4.9	3	915.090-III	18,75
M6	1.00	Serie	56	19	6.0	8	4.9	3	915.090-S	56,30

3.119.710-LH

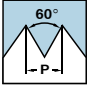
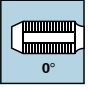
d₁	P	Tipo	l₁	l₂	d₂	l	a	z	Codice	€
M8	1.25	No.1	63	22	6.0	8	4.9	4	915.100-I	21,80
M8	1.25	No.2	63	22	6.0	8	4.9	4	915.100-II	21,80
M8	1.25	No.3	63	22	6.0	8	4.9	4	915.100-III	21,80
M8	1.25	Serie	63	22	6.0	8	4.9	4	915.100-S	65,40
M10	1.50	No.1	70	24	7.0	8	5.5	4	915.110-I	27,20
M10	1.50	No.2	70	24	7.0	8	5.5	4	915.110-II	27,20
M10	1.50	No.3	70	24	7.0	8	5.5	4	915.110-III	27,20
M10	1.50	Serie	70	24	7.0	8	5.5	4	915.110-S	81,50
M12	1.75	No.1	75	28	9.0	10	7	4	915.120-I	32,00
M12	1.75	No.2	75	28	9.0	10	7	4	915.120-II	32,00
M12	1.75	No.3	75	28	9.0	10	7	4	915.120-III	32,00
M12	1.75	Serie	75	28	9.0	10	7	4	915.120-S	96,00
M14	2.00	No.1	80	30	11.0	12	9	4	915.125-I	45,80
M14	2.00	No.2	80	30	11.0	12	9	4	915.125-II	45,80
M14	2.00	No.3	80	30	11.0	12	9	4	915.125-III	45,80
M14	2.00	Serie	80	30	11.0	12	9	4	915.125-S	137,50
M16	2.00	No.1	80	32	12.0	12	9	4	915.130-I	52,10
M16	2.00	No.2	80	32	12.0	12	9	4	915.130-II	52,10
M16	2.00	No.3	80	32	12.0	12	9	4	915.130-III	52,10
M16	2.00	Serie	80	32	12.0	12	9	4	915.130-S	156,50
M18	2.50	No.1	95	34	14.0	14	11	4	915.135-I	72,00
M18	2.50	No.2	95	34	14.0	14	11	4	915.135-II	72,00
M18	2.50	No.3	95	34	14.0	14	11	4	915.135-III	72,00
M18	2.50	Serie	95	34	14.0	14	11	4	915.135-S	216,00
M20	2.50	No.1	95	34	16.0	15	12	4	915.140-I	75,90
M20	2.50	No.2	95	34	16.0	15	12	4	915.140-II	75,90
M20	2.50	No.3	95	34	16.0	15	12	4	915.140-III	75,90
M20	2.50	Serie	95	34	16.0	15	12	4	915.140-S	227,50
M22	2.50	No.1	100	34	18.0	17	14.5	4	915.145-I	79,70
M22	2.50	No.2	100	34	18.0	17	14.5	4	915.145-II	79,70
M22	2.50	No.3	100	34	18.0	17	14.5	4	915.145-III	79,70
M22	2.50	Serie	100	34	18.0	17	14.5	4	915.145-S	239,00
M24	3.00	No.1	110	38	18.0	17	14.5	4	915.150-I	80,30
M24	3.00	No.2	110	38	18.0	17	14.5	4	915.150-II	80,30
M24	3.00	No.3	110	38	18.0	17	14.5	4	915.150-III	80,30
M24	3.00	Serie	110	38	18.0	17	14.5	4	915.150-S	241,00

No. 1			<div style="display: flex; flex-wrap: wrap; gap: 10px;"> <div style="border: 1px solid black; padding: 5px; width: 50%;">Acciaio INOX</div> <div style="border: 1px solid black; padding: 5px; width: 50%;">Acciaio 500-800 N/mm²</div> <div style="border: 1px solid black; padding: 5px; width: 50%;">Acciaio 800-1200 N/mm²</div> <div style="border: 1px solid black; padding: 5px; width: 50%;">OTTONE</div> <div style="border: 1px solid black; padding: 5px; width: 50%;">ALU Si <10%</div> <div style="border: 1px solid black; padding: 5px; width: 50%;">Ni</div> </div>	
	No. 2			
		No. 3		

MASCHI A MANO

M	 60° -P-	 0°	OX HSSE V3		
	>2xd" data-bbox="208 428 278 478"/> >2xd		 SECCO	 EMULSIONE	 OLIO

6.119.721

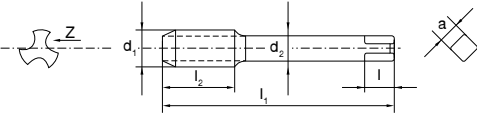





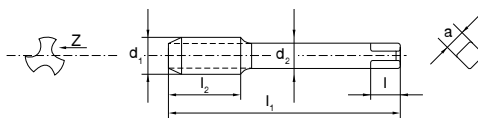

DIN 352

d ₁	P	Tipo	l ₁	l ₂	d ₂	l	a	z	Codice	€
M2	0.40	No.1	36	8	2.8	5	2.1	3	920.040-I	15,60
M2	0.40	No.2	36	8	2.8	5	2.1	3	920.040-II	15,60
M2	0.40	No.3	36	8	2.8	5	2.1	3	920.040-III	15,60
M2	0.40	Serie	36	8	2.8	5	2.1	3	920.040-S	46,70
M2.5	0.45	No.1	40	9	2.8	5	2.1	3	920.055-I	13,95
M2.5	0.45	No.2	40	9	2.8	5	2.1	3	920.055-II	13,95
M2.5	0.45	No.3	40	9	2.8	5	2.1	3	920.055-III	13,95
M2.5	0.45	Serie	40	9	2.8	5	2.1	3	920.055-S	41,90
M3	0.50	No.1	40	11	3.5	6	2.7	3	920.065-I	10,62
M3	0.50	No.2	40	11	3.5	6	2.7	3	920.065-II	10,62
M3	0.50	No.3	40	11	3.5	6	2.7	3	920.065-III	10,62
M3	0.50	Serie	40	11	3.5	6	2.7	3	920.065-S	31,85
M3.5	0.60	No.1	45	12	4.0	6	3	3	920.070-I	12,35
M3.5	0.60	No.2	45	12	4.0	6	3	3	920.070-II	12,35
M3.5	0.60	No.3	45	12	4.0	6	3	3	920.070-III	12,35
M3.5	0.60	Serie	45	12	4.0	6	3	4	920.070-S	37,05



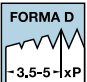

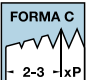

6.119.721

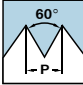
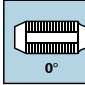
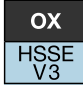

d ₁	P	Tipo	l ₁	l ₂	d ₂	l	a	z	Codice	€
M4	0.70	No.1	45	13	4.5	6	3.4	3	920.075-I	10,62
M4	0.70	No.2	45	13	4.5	6	3.4	3	920.075-II	10,62
M4	0.70	No.3	45	13	4.5	6	3.4	3	920.075-III	10,62
M4	0.70	Serie	45	13	4.5	6	3.4	3	920.075-S	31,85
M5	0.80	No.1	50	16	6.0	8	4.9	3	920.085-I	11,59
M5	0.80	No.2	50	16	6.0	8	4.9	3	920.085-II	11,59
M5	0.80	No.3	50	16	6.0	8	4.9	3	920.085-III	11,59
M5	0.80	Serie	50	16	6.0	8	4.9	3	920.085-S	34,80
M6	1.00	No.1	56	19	6.0	8	4.9	3	920.090-I	11,97
M6	1.00	No.2	56	19	6.0	8	4.9	3	920.090-II	11,97
M6	1.00	No.3	56	19	6.0	8	4.9	3	920.090-III	11,97
M6	1.00	Serie	56	19	6.0	8	4.9	3	920.090-S	35,90
M8	1.25	No.1	63	22	6.0	8	4.9	4	920.100-I	12,82
M8	1.25	No.2	63	22	6.0	8	4.9	4	920.100-II	12,82
M8	1.25	No.3	63	22	6.0	8	4.9	4	920.100-III	12,82
M8	1.25	Serie	63	22	6.0	8	4.9	4	920.100-S	38,50
M10	1.50	No.1	70	24	7.0	8	5.5	4	920.110-I	16,90
M10	1.50	No.2	70	24	7.0	8	5.5	4	920.110-II	16,90
M10	1.50	No.3	70	24	7.0	8	5.5	4	920.110-III	16,90
M10	1.50	Serie	70	24	7.0	8	5.5	4	920.110-S	50,70
M12	1.75	No.1	75	28	9.0	10	7	4	920.120-I	21,90
M12	1.75	No.2	75	28	9.0	10	7	4	920.120-II	21,90
M12	1.75	No.3	75	28	9.0	10	7	4	920.120-III	21,90
M12	1.75	Serie	75	28	9.0	10	7	4	920.120-S	65,70
M14	2.00	No.1	80	30	11.0	12	9	4	920.125-I	28,95
M14	2.00	No.2	80	30	11.0	12	9	4	920.125-II	28,95
M14	2.00	No.3	80	30	11.0	12	9	4	920.125-III	28,95
M14	2.00	Serie	80	30	11.0	12	9	4	920.125-S	86,80
M16	2.00	No.1	80	32	12.0	12	9	4	920.130-I	35,50
M16	2.00	No.2	80	32	12.0	12	9	4	920.130-II	35,50
M16	2.00	No.3	80	32	12.0	12	9	4	920.130-III	35,50
M16	2.00	Serie	80	32	12.0	12	9	4	920.130-S	106,50

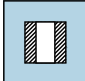
<p>No. 1</p> 	<p>FORMA A</p>  <p>6-8 -xP</p>	<p>PILOTA</p> <p>90°</p>	<p>Acciaio INOX</p>	<p>Acciaio 500-800 N/mm²</p>
<p>No. 2</p> 	<p>FORMA D</p>  <p>3,5-5 -xP</p>		<p>Acciaio 800-1200 N/mm²</p>	<p>OTTONE</p>
<p>No. 3</p> 	<p>FORMA C</p>  <p>2-3 -xP</p>	<p>ISO 2 (6H)</p>	<p>ALU Si <10%</p>	<p>Ni</p>

MASCHI A MANO

			
	>2xd chip symbol" data-bbox="208 425 275 472"/>		
			
			

6.119.721-P

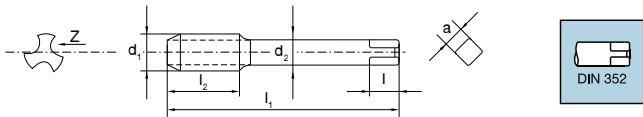

d ₁	P	Tipo	l ₁	l ₂	d ₂	l	a	z	Codice	€
M2	0.40	No.1	36	8	2.8	5	2.1	3	925.040-I	14,86
M2	0.40	No.2	36	8	2.8	5	2.1	3	920.040-II	15,60
M2	0.40	No.3	36	8	2.8	5	2.1	3	920.040-III	15,60
M2	0.40	Serie	36	8	2.8	5	2.1	3	925.040-S	44,60
M2.5	0.45	No.1	40	9	2.8	5	2.1	3	925.055-I	13,32
M2.5	0.45	No.2	40	9	2.8	5	2.1	3	920.055-II	13,95
M2.5	0.45	No.3	40	9	2.8	5	2.1	3	920.055-III	13,95
M2.5	0.45	Serie	40	9	2.8	5	2.1	3	925.055-S	39,95
M3	0.50	No.1	40	11	3.5	6	2.7	3	925.065-I	10,15
M3	0.50	No.2	40	11	3.5	6	2.7	3	920.065-II	10,62
M3	0.50	No.3	40	11	3.5	6	2.7	3	920.065-III	10,62
M3	0.50	Serie	40	11	3.5	6	2.7	3	925.065-S	30,45
M3.5	0.60	No.1	45	12	4.0	6	3	3	925.070-I	12,03
M3.5	0.60	No.2	45	12	4.0	6	3	3	920.070-II	12,35
M3.5	0.60	No.3	45	12	4.0	6	3	3	920.070-III	12,35
M3.5	0.60	Serie	45	12	4.0	6	3	4	925.070-S	36,10

6.119.721-P

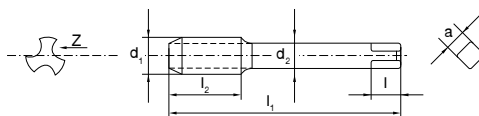

d ₁	P	Tipo	l ₁	l ₂	d ₂	l	a	z	Codice	€
M4	0.70	No.1	45	13	4.5	6	3.4	3	925.075-I	10,15
M4	0.70	No.2	45	13	4.5	6	3.4	3	920.075-II	10,62
M4	0.70	No.3	45	13	4.5	6	3.4	3	920.075-III	10,62
M4	0.70	Serie	45	13	4.5	6	3.4	3	925.075-S	30,45
M5	0.80	No.1	50	16	6.0	8	4.9	3	925.085-I	11,08
M5	0.80	No.2	50	16	6.0	8	4.9	3	920.085-II	11,59
M5	0.80	No.3	50	16	6.0	8	4.9	3	920.085-III	11,59
M5	0.80	Serie	50	16	6.0	8	4.9	3	925.085-S	33,25
M6	1.00	No.1	56	19	6.0	8	4.9	3	925.090-I	11,43
M6	1.00	No.2	56	19	6.0	8	4.9	3	920.090-II	11,97
M6	1.00	No.3	56	19	6.0	8	4.9	3	920.090-III	11,97
M6	1.00	Serie	56	19	6.0	8	4.9	3	925.090-S	34,30
M8	1.25	No.1	63	22	6.0	8	4.9	4	925.100-I	12,25
M8	1.25	No.2	63	22	6.0	8	4.9	4	920.100-II	12,82
M8	1.25	No.3	63	22	6.0	8	4.9	4	920.100-III	12,82
M8	1.25	Serie	63	22	6.0	8	4.9	4	925.100-S	36,75
M10	1.50	No.1	70	24	7.0	8	5.5	4	925.110-I	16,20
M10	1.50	No.2	70	24	7.0	8	5.5	4	920.110-II	16,90
M10	1.50	No.3	70	24	7.0	8	5.5	4	920.110-III	16,90
M10	1.50	Serie	70	24	7.0	8	5.5	4	925.110-S	48,60
M12	1.75	No.1	75	28	9.0	10	7	4	925.120-I	20,65
M12	1.75	No.2	75	28	9.0	10	7	4	920.120-II	21,90
M12	1.75	No.3	75	28	9.0	10	7	4	920.120-III	21,90
M12	1.75	Serie	75	28	9.0	10	7	4	925.120-S	61,90
M14	2.00	No.1	80	30	11.0	12	9	4	925.125-I	27,30
M14	2.00	No.2	80	30	11.0	12	9	4	920.125-II	28,95
M14	2.00	No.3	80	30	11.0	12	9	4	920.125-III	28,95
M14	2.00	Serie	80	30	11.0	12	9	4	925.125-S	81,80
M16	2.00	No.1	80	32	12.0	12	9	4	925.130-I	33,50
M16	2.00	No.2	80	32	12.0	12	9	4	920.130-II	35,50
M16	2.00	No.3	80	32	12.0	12	9	4	920.130-III	35,50
M16	2.00	Serie	80	32	12.0	12	9	4	925.130-S	100,50

No. 1



No. 2



ISO2
(6H)

Acciaio
≤ 500
N/mm²

Acciaio
500-800
N/mm²

ALU
Si <10%

CU

MASCHI A MANO



3.219.810

d ₁	P	Tipo	l ₁	l ₂	d ₂	l	a	z	Codice	€
M2	0.25	No.1	36	8	2.8	5	2.1	3	930.000-I	22,30
M2	0.25	No.2	36	8	2.8	5	2.1	3	930.000-II	22,30
M2	0.25	Serie	36	8	2.8	5	2.1	4	930.000-S	44,60
M2.5	0.35	No.1	40	9	2.8	5	2.1	3	930.005-I	20,30
M2.5	0.35	No.2	40	9	2.8	5	2.1	3	930.005-II	20,30
M2.5	0.35	Serie	40	9	2.8	5	2.1	3	930.005-S	40,50
M3	0.35	No.1	40	8	3.5	6	2.7	3	930.015-I	16,20
M3	0.35	No.2	40	8	3.5	6	2.7	3	930.015-II	16,20
M3	0.35	Serie	40	8	3.5	6	2.7	3	930.015-S	32,35
M3.5	0.35	No.1	45	9	4.0	6	3	3	930.020-I	22,60
M3.5	0.35	No.2	45	9	4.0	6	3	3	930.020-II	22,60
M3.5	0.35	Serie	45	9	4.0	6	3	3	930.020-S	45,10
M4	0.35	No.1	45	10	4.5	6	3.4	3	930.025-I	22,30
M4	0.35	No.2	45	10	4.5	6	3.4	3	930.025-II	22,30
M4	0.35	Serie	45	10	4.5	6	3.4	3	930.025-S	44,60

3.219.810

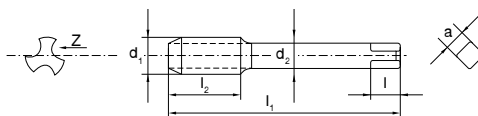

d ₁	P	Tipo	l ₁	l ₂	d ₂	l	a	z	Codice	€
M12	1.00	No.1	70	22	9.0	10	7	4	930.100-I	18,60
M12	1.00	No.2	70	22	9.0	10	7	4	930.100-II	18,60
M12	1.00	Serie	70	22	9.0	10	7	4	930.100-S	37,20
M12	1.25	No.1	70	22	9.0	10	7	4	930.105-I	23,65
M12	1.25	No.2	70	22	9.0	10	7	4	930.105-II	23,65
M12	1.25	Serie	70	22	9.0	10	7	4	930.105-S	47,30
M12	1.50	No.1	70	22	9.0	10	7	4	930.110-I	18,25
M12	1.50	No.2	70	22	9.0	10	7	4	930.110-II	18,25
M12	1.50	Serie	70	22	9.0	10	7	4	930.110-S	36,45
M14	1.00	No.1	70	22	11.0	12	9	4	930.120-I	27,10
M14	1.00	No.2	70	22	11.0	12	9	4	930.120-II	27,10
M14	1.00	Serie	70	22	11.0	12	9	4	930.120-S	54,20
M14	1.25	No.1	70	22	11.0	12	9	4	930.125-I	28,65
M14	1.25	No.2	70	22	11.0	12	9	4	930.125-II	28,65
M14	1.25	Serie	70	22	11.0	12	9	4	930.125-S	57,30
M14	1.50	No.1	70	22	11.0	12	9	4	930.130-I	22,90
M14	1.50	No.2	70	22	11.0	12	9	4	930.130-II	22,90
M14	1.50	Serie	70	22	11.0	12	9	4	930.130-S	45,80
M15	1.50	No.1	80	22	12.0	12	9	4	930.140-I	31,05
M15	1.50	No.2	80	22	12.0	12	9	4	930.140-II	31,05
M15	1.50	Serie	80	22	12.0	12	9	4	930.140-S	54,20
M16	1.00	No.1	80	22	12.0	12	9	4	930.145-I	29,20
M16	1.00	No.2	80	22	12.0	12	9	4	930.145-II	29,20
M16	1.00	Serie	80	22	12.0	12	9	4	930.145-S	58,30
M16	1.50	No.1	80	22	12.0	12	9	4	930.150-I	23,95
M16	1.50	No.2	80	22	12.0	12	9	4	930.150-II	23,95
M16	1.50	Serie	80	22	12.0	12	9	4	930.150-S	47,90
M18	1.00	No.1	80	22	14.0	14	11	4	930.155-I	39,45
M18	1.00	No.2	80	22	14.0	14	11	4	930.155-II	39,45
M18	1.00	Serie	80	22	14.0	14	11	4	930.155-S	78,80
M18	1.50	No.1	80	22	14.0	14	11	4	930.160-I	35,05
M18	1.50	No.2	80	22	14.0	14	11	4	930.160-II	35,05
M18	1.50	Serie	80	22	14.0	14	11	4	930.160-S	70,10
M18	2.00	No.1	80	22	14.0	14	11	4	930.165-I	40,70
M18	2.00	No.2	80	22	14.0	14	11	4	930.165-II	40,70
M18	2.00	Serie	80	22	14.0	14	11	4	930.165-S	81,30

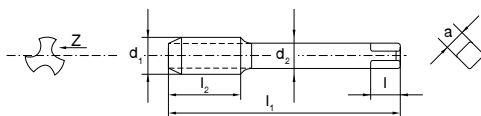
3.219.810

d_1	P	Tipo	l_1	l_2	d_2	l	a	z	Codice	€
M30	2.00	No.1	90	22	22.0	21	18	4	930.250-I	87,30
M30	2.00	No.2	90	22	22.0	21	18	4	930.250-II	87,30
M30	2.00	Serie	90	22	22.0	21	18	4	930.250-S	174,50
M32	1.50	No.1	90	22	22.0	21	18	4	930.255-I	90,00
M32	1.50	No.2	90	22	22.0	21	18	4	930.255-II	90,00
M32	1.50	Serie	90	22	22.0	21	18	4	930.255-S	180,00
M33	2.00	No.1	100	25	25.0	23	20	4	930.265-I	115,00
M33	2.00	No.2	100	25	25.0	23	20	4	930.265-II	115,00
M33	2.00	Serie	100	25	25.0	23	20	4	930.265-S	230,00
M36	1.50	No.1	100	25	28.0	25	22	4	930.280-I	118,50
M36	1.50	No.2	100	25	28.0	25	22	4	930.280-II	118,50
M36	1.50	Serie	100	25	28.0	25	22	4	930.280-S	237,00
M36	2.00	No.1	125	40	28.0	25	22	4	930.285-I	130,00
M36	2.00	No.2	125	40	28.0	25	22	4	930.285-II	130,00
M36	2.00	Serie	125	40	28.0	25	22	4	930.285-S	260,00
M36	3.00	No.1	125	40	28.0	25	22	4	930.290-I	137,50
M36	3.00	No.2	125	40	28.0	25	22	4	930.290-II	137,50
M36	3.00	Serie	125	40	28.0	25	22	4	930.290-S	274,00
M38	1.50	No.1	100	25	28.0	25	22	4	930.295-I	129,50
M38	1.50	No.2	100	25	28.0	25	22	4	930.295-II	129,50
M38	1.50	Serie	100	25	28.0	25	22	4	930.295-S	259,00
M39	2.00	No.1	125	40	32.0	27	24	4	930.300-I	168,50
M39	2.00	No.2	125	40	32.0	27	24	4	930.300-II	168,50
M39	2.00	Serie	125	40	32.0	27	24	4	930.300-S	337,00
M39	3.00	No.1	125	40	32.0	27	24	4	930.305-I	174,50
M39	3.00	No.2	125	40	32.0	27	24	4	930.305-II	174,50
M39	3.00	Serie	125	40	32.0	27	24	4	930.305-S	349,00
M40	1.50	No.1	110	25	32.0	27	24	4	930.310-I	154,50
M40	1.50	No.2	110	25	32.0	27	24	4	930.310-II	154,50
M40	1.50	Serie	110	25	32.0	27	24	4	930.310-S	309,00
M40	2.00	No.1	125	40	32.0	27	24	4	930.315-I	164,00
M40	2.00	No.2	125	40	32.0	27	24	4	930.315-II	164,00
M40	2.00	Serie	125	40	32.0	27	24	4	930.315-S	328,00
M40	3.00	No.1	125	40	32.0	27	24	4	930.320-I	175,50
M40	3.00	No.2	125	40	32.0	27	24	4	930.320-II	175,50
M40	3.00	Serie	125	40	32.0	27	24	4	930.320-S	351,00

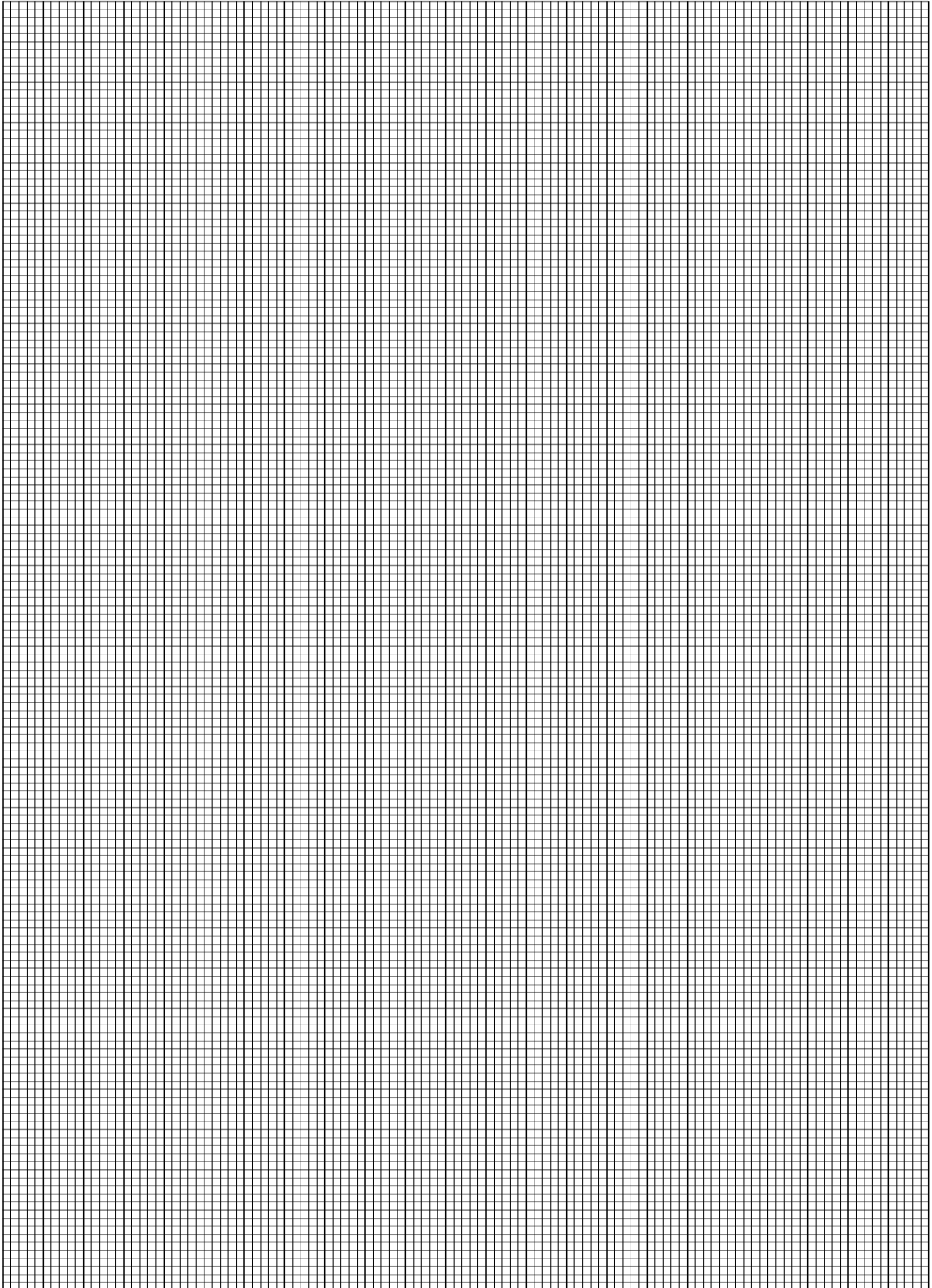

3.399.710

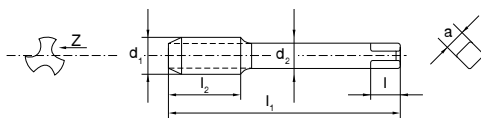

d_1	Filetti x pollice	Tipo	l_1	l_2	d_2	l	a	z	Codice	€
No.4	40	No.1	40	11	3.5	6	2.7	3	940.020-I	11,85
No.4	40	No.2	40	11	3.5	6	2.7	3	940.020-II	11,85
No.4	40	No.3	40	11	3.5	6	2.7	3	940.020-III	11,85
No.4	40	Serie	40	11	3.5	6	2.7	3	940.020-S	35,60
No.5	40	No.1	40	11	3.5	6	2.7	3	940.025-I	11,79
No.5	40	No.2	40	11	3.5	6	2.7	3	940.025-II	11,79
No.5	40	No.3	40	11	3.5	6	2.7	3	940.025-III	11,79
No.5	40	Serie	40	11	3.5	6	2.7	3	940.025-S	35,40
No.6	32	No.1	45	12	4.0	6	3	3	940.030-I	11,73
No.6	32	No.2	45	12	4.0	6	3	3	940.030-II	11,73
No.6	32	No.3	45	12	4.0	6	3	3	940.030-III	11,73
No.6	32	Serie	45	12	4.0	6	3	3	940.030-S	35,25
No.8	32	No.1	45	13	4.5	6	3.4	3	940.035-I	11,85
No.8	32	No.2	45	13	4.5	6	3.4	3	940.035-II	11,85
No.8	32	No.3	45	13	4.5	6	3.4	3	940.035-III	11,85
No.8	32	Serie	45	13	4.5	6	3.4	3	940.035-S	35,60
No.10	24	No.1	50	16	6.0	7	4.9	3	940.040-I	12,41
No.10	24	No.2	50	16	6.0	7	4.9	3	940.040-II	12,41
No.10	24	No.3	50	16	6.0	7	4.9	3	940.040-III	12,41
No.10	24	Serie	50	16	6.0	7	4.9	3	940.040-S	37,25
No.12	24	No.1	50	16	6.0	8	4.9	3	940.045-I	13,67
No.12	24	No.2	50	16	6.0	8	4.9	3	940.045-II	13,67
No.12	24	No.3	50	16	6.0	8	4.9	3	940.045-III	13,67
No.12	24	Serie	50	16	6.0	8	4.9	3	940.045-S	41,10
1/4	20	No.1	56	19	6.0	8	4.9	3	940.050-I	12,54
1/4	20	No.2	56	19	6.0	8	4.9	3	940.050-II	12,54
1/4	20	No.3	56	19	6.0	8	4.9	3	940.050-III	12,54
1/4	20	Serie	56	19	6.0	8	4.9	3	940.050-S	37,65
5/16	18	No.1	63	22	6.0	8	4.9	4	940.055-I	14,03
5/16	18	No.2	63	22	6.0	8	4.9	4	940.055-II	14,03
5/16	18	No.3	63	22	6.0	8	4.9	4	940.055-III	14,03
5/16	18	Serie	63	22	6.0	8	4.9	4	940.055-S	42,10
3/8	16	No.1	63	22	7.0	8	5.5	4	940.060-I	16,45
3/8	16	No.2	63	22	7.0	8	5.5	4	940.060-II	16,45
3/8	16	No.3	63	22	7.0	8	5.5	4	940.060-III	16,45
3/8	16	Serie	63	22	7.0	8	5.5	4	940.060-S	49,40

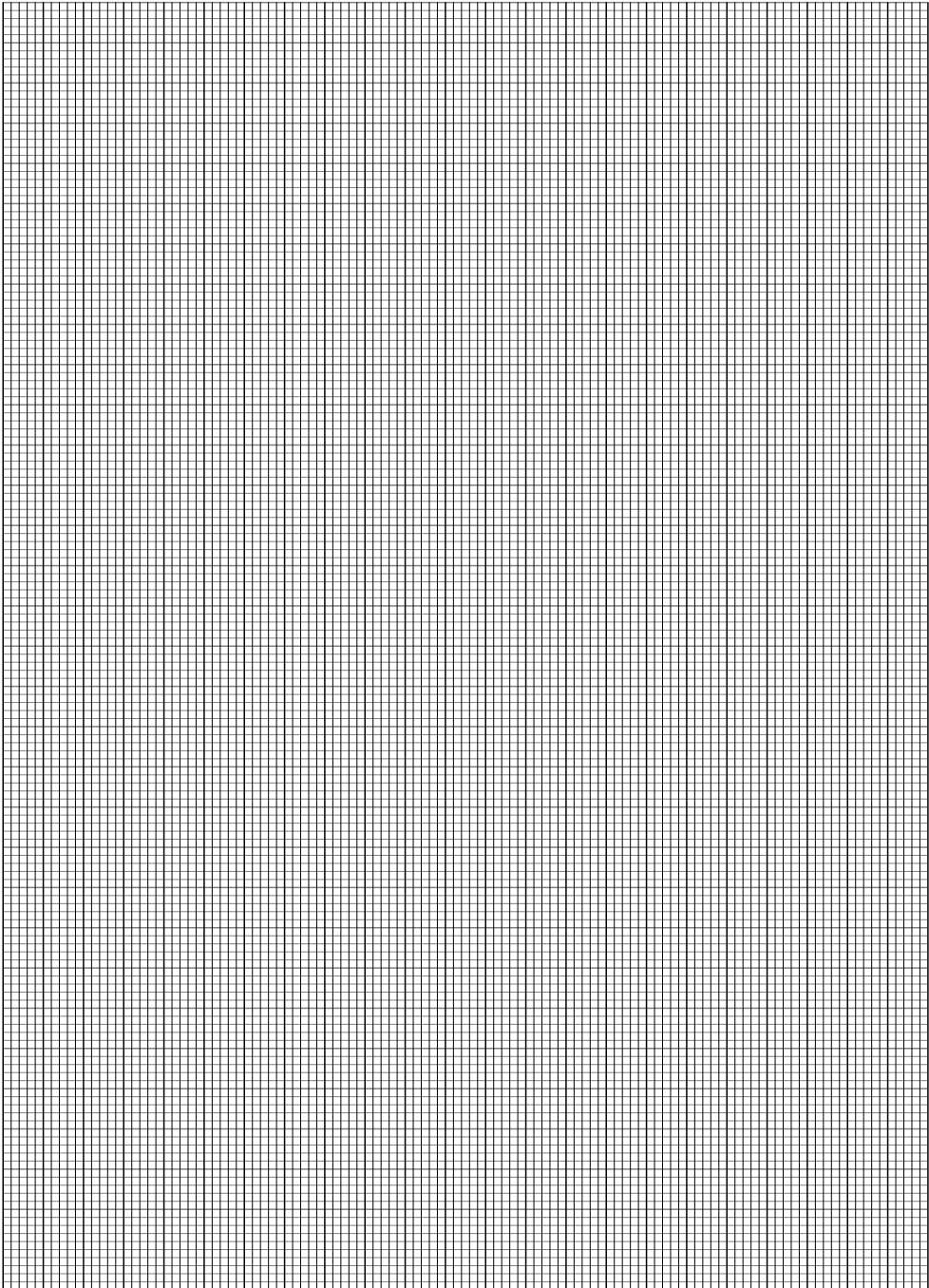

No. 1



No. 2



2B
B1.1

Acciaio
≤ 500
N/mm²

Acciaio
500-800
N/mm²

ALU
Si <10%

CU

MASCHI A MANO

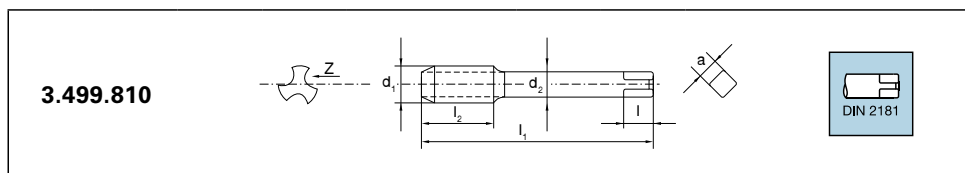
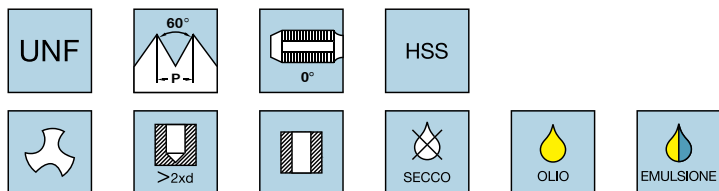

d ₁	Filetti x pollice	Tipo	l ₁	l ₂	d ₂	l	a	z	Codice	€
No.0	80	No.1	32	8	2.5	5	2.1	3	945.005-I	20,70
No.0	80	No.2	32	8	2.5	5	2.1	3	945.005-II	20,70
No.0	80	Serie	32	8	2.5	5	2.1	3	945.005-S	41,40
No.1	72	No.1	36	8	2.8	5	2.1	3	945.010-I	19,40
No.1	72	No.2	36	8	2.8	5	2.1	3	945.010-II	19,40
No.1	72	Serie	36	8	2.8	5	2.1	3	945.010-S	38,80
No.2	64	No.1	36	9	2.8	5	2.1	3	945.015-I	18,05
No.2	64	No.2	36	9	2.8	5	2.1	3	945.015-II	18,05
No.2	64	Serie	36	9	2.8	5	2.1	3	945.015-S	36,05
No.3	56	No.1	40	9	2.8	5	2.1	3	945.020-I	15,70
No.3	56	No.2	40	9	2.8	5	2.1	3	945.020-II	15,70
No.3	56	Serie	40	9	2.8	5	2.1	3	945.020-S	31,35
									CONTINUA	

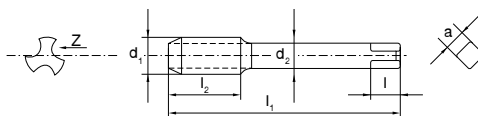
3.499.810

d_1	Filetti x pollice	Tipo	l_1	l_2	d_2	l	a	z	Codice	€
No.4	48	No.1	40	8	3.5	6	2.7	3	945.025-I	14,01
No.4	48	No.2	40	8	3.5	6	2.7	3	945.025-II	14,01
No.4	48	Serie	40	8	3.5	6	2.7	3	945.025-S	28,05
No.5	44	No.1	40	8	3.5	6	2.7	3	945.030-I	13,65
No.5	44	No.2	40	8	3.5	6	2.7	3	945.030-II	13,65
No.5	44	Serie	40	8	3.5	6	2.7	3	945.030-S	27,35
No.6	40	No.1	45	9	4.0	6	3	3	945.035-I	13,65
No.6	40	No.2	45	9	4.0	6	3	3	945.035-II	13,65
No.6	40	Serie	45	9	4.0	6	3	3	945.035-S	27,35
No.8	36	No.1	45	10	4.5	6	3.4	3	945.040-I	13,22
No.8	36	No.2	45	10	4.5	6	3.4	3	945.040-II	13,22
No.8	36	Serie	45	10	4.5	6	3.4	3	945.040-S	26,45
No.10	32	No.1	56	12	6.0	7	4.9	3	945.045-I	13,65
No.10	32	No.2	50	12	6.0	7	4.9	3	945.045-II	13,65
No.10	32	Serie	50	12	6.0	7	4.9	3	945.045-S	27,35
No.12	28	No.1	50	12	6.0	8	4.9	3	945.050-I	14,33
No.12	28	No.2	50	12	6.0	8	4.9	3	945.050-II	14,33
No.12	28	Serie	50	12	6.0	8	4.9	3	945.050-S	28,65
1/4	28	No.1	56	14	6.0	8	4.9	3	945.055-I	14,02
1/4	28	No.2	56	14	6.0	8	4.9	3	945.055-II	14,02
1/4	28	Serie	56	14	6.0	8	4.9	3	945.055-S	28,05
5/16	24	No.1	63	22	6.0	8	4.9	4	945.060-I	16,70
5/16	24	No.2	63	22	6.0	8	4.9	4	945.060-II	16,70
5/16	24	Serie	63	22	6.0	8	4.9	3	945.060-S	33,35
3/8	24	No.1	63	20	7.0	8	5.5	4	945.065-I	17,40
3/8	24	No.2	63	20	7.0	8	5.5	4	945.065-II	17,40
3/8	24	Serie	63	20	7.0	8	5.5	4	945.065-S	34,75
7/16	20	No.1	63	20	8.0	9	6.2	4	945.070-I	21,80
7/16	20	No.2	63	20	8.0	9	6.2	4	945.070-II	21,80
7/16	20	Serie	63	20	8.0	9	6.2	4	945.070-S	43,70
1/2	20	No.1	70	22	9.0	10	7	4	945.075-I	23,90
1/2	20	No.2	70	22	9.0	10	7	4	945.075-II	23,90
1/2	20	Serie	70	22	9.0	10	7	4	945.075-S	47,80
9/16	18	No.1	70	22	11.0	12	9	4	945.080-I	34,35
9/16	18	No.2	70	22	11.0	12	9	4	945.080-II	34,35
9/16	18	Serie	70	22	11.0	12	9	4	945.080-S	68,70

No. 1



No. 2



Acciaio
≤ 500
N/mm²

Acciaio
500-800
N/mm²

ALU
Si <10%

CU

MASCHI A MANO



3.699.510

d ₁	Filetti x pollice	Tipo	l ₁	l ₂	d ₂	l	a	z	Codice	€
1/8	28	No.1	63	20	7.0	8	5.5	4	935.010-I	16,50
1/8	28	No.2	63	20	7.0	8	5.5	4	935.010-II	16,50
1/8	28	Serie	63	20	7.0	8	5.5	4	935.010-S	33,00
1/4	19	No.1	70	22	11.0	12	9	4	935.015-I	22,00
1/4	19	No.2	70	22	11.0	12	9	4	935.015-II	22,00
1/4	19	Serie	70	22	11.0	12	9	4	935.015-S	44,00
3/8	19	No.1	70	22	12.0	12	9	4	935.020-I	26,35
3/8	19	No.2	70	22	12.0	12	9	4	935.020-II	26,35
3/8	19	Serie	70	22	12.0	12	9	4	935.020-S	52,70
1/2	14	No.1	80	22	16.0	15	12	4	935.025-I	38,10
1/2	14	No.2	80	22	16.0	15	12	4	935.025-II	38,10
1/2	14	Serie	80	22	16.0	15	12	4	935.025-S	76,20
5/8	14	No.1	80	22	18.0	17	14.5	4	935.030-I	46,30
5/8	14	No.2	80	22	18.0	17	14.5	4	935.030-II	46,30
5/8	14	Serie	80	22	18.0	17	14.5	4	935.030-S	92,60

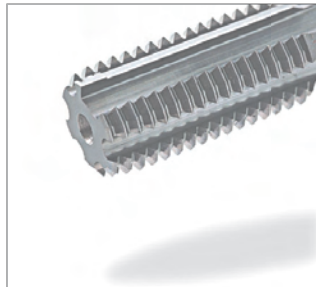
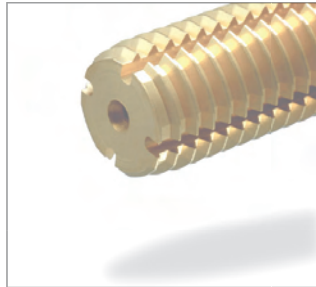

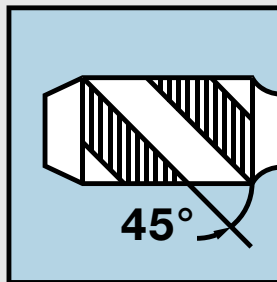

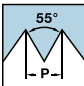
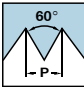
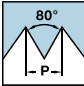

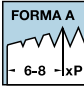
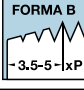
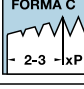
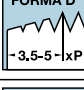
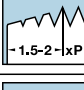
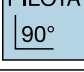









ICONE

Icone	Tipi di filettatura	Icone	Angoli di filettatura
DIN 13	Filetto metrico secondo ISO68/DIN13		Angolo di filettatura a 55° (G)
DIN 40430	PG secondo DIN40430		Angolo di filettatura a 60°
G	Filetto Whitworth DIN/ISO 228		Angolo di filettatura a 80° (PG)
ISO 228	ISO / DIN 228		
LH	Filetto sinistro		
M	Filetto metrico ISO68/DIN13	Icone	Filetto con esecuzione speciale
MF	Filetto metrico Fine ISO68 / DIN13	AT	Filetto alternato
NPT	Filetto conico 1:16 ASME/ANSI B1.20.1	BT	Rastremato
PG	Filetto per tubi di protezione conduttori elettrici DIN40430		
S MINI	Micro filetti ISO / DIN 1501		
UNC	Filetto Americano normale ASME / ANSI B1.1		
UNF	Filetto Americano Fine ASME / ANSI B1.1		

Icone	Tolleranze	Icone	Tipi di imbocco
2B B1.1	Tolleranza 2B ANSI/ASME B1.1		Imbocco forma A Lunghezza = 6-8 x passo del filetto
4HX	Tolleranza 4HX		Imbocco forma B Lunghezza = 3.5-5.5 x passo del filetto con imbocco corretto
5HX	Tolleranza 5HX		Imbocco forma C Lunghezza = 2-3 x passo del filetto
6HX	Tolleranza 6HX		Imbocco forma D Lunghezza = 3.5-5 x passo del filetto
6GX	Tolleranza 6GX		Imbocco forma E Lunghezza = 1.5-2 x passo del filetto
7G	Tolleranza 7G		Con pilota di guida per maschi a mano
ANSI B1.1	Secondo ASME/ANSI B1.1 Standard		
ISO 1 (5H)	Tolleranza ISO1 / 5H		
ISO 2 (6H)	Tolleranza ISO 2 / 6H		
ISO 3 (6G)	Tolleranza ISO 3 / 6G		

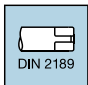
Icone	Forma tagliente	Icone	Tipi di preforo
	Elica dritta con imbocco corretto forma B		Foro cieco cilindrico con profondità massima = 2.5 x diametro
	Elica dritta		Foro cieco cilindrico con profondità massima > 2.5 x diametro
	Elica destra 10°		Foro passante cilindrico
	LSP Elica sinistra 15°		Foro passante cilindrico in metalli sottili
	Elica destra 15°		Foro cieco conico
	Elica destra 35°		Foro passante conico
	Elica destra 40°		Foro passante conico con fondo sottile
	Elica destra 45° Lubrificazione interna assiale		
	Elica destra 45°	Icone	Lubrificazione
	Elica destra 50° Lubrificazione interna assiale		Maschiatura a secco
	Elica destra 50°		Maschiatura con emulsioni al 10%
	Lubrificazione interna assiale		Maschiatura con olio da taglio
	forma B Lubrificazione interna radiale		

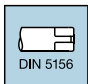
Icone	Materiali e Rivestimenti	Icone	Materiali e Rivestimenti
	Rivestimento: Balinit Hardlube Corpo: Vanadium HSS		HSS
	Rivestimento: Balinit Hardlube Corpo: Vanadium HSS-PM (Sinterizzato)		HSSE High Speed Steel E con contenuto di Vanadio di ~ 3%
	Rivestimento: Nitrurato e Vaporizzato Corpo: Vanadium HSS		Metallo duro in micrograna
	Rivestimento: Nitrurato e Vaporizzato Corpo: Vanadium HSS-PM		HSS-PM (Sinterizzato)
	Rivestimento: Vaporizzato Corpo: Vanadium HSS		HSS-PM (Sinterizzato) con contenuto di 3% V e 8% Co
	Rivestimento: Vaporizzato Corpo: Vanadium HSS-PM		
	Rivestimento: Titanium CarboNitrIde Corpo: Vanadium HSS	Icone	Tipi di maschi
	Rivestimento: Titanium CarboNitrIde Corpo: Vanadium HSS-PM		Con asportazione truciolo
	Rivestimento: Titanium CarboNitrIde Corpo: metallo duro in micrograna		Con deformazione materiale e canalini di lubrificazione
	Rivestimento: Titanium Nitride Corpo: Vanadium HSS		Con deformazione materiale
	Rivestimento: Titanium Nitride Corpo: Vanadium HSS-PM		
	Rivestimento: Multistrato Corpo: Vanadium HSS		
	Rivestimento: Multistrato Corpo: Vanadium HSS-PM		

Icone	Tipo Attacco	Icone	Tipo Attacco
	Gambo dell'utensile secondo DIN 352		Gambo dell'utensile di lunghezza doppia norme Tanoi
	Gambo dell'utensile secondo DIN 371		Gambo dell'utensile norme Tanoi
	Gambo dell'utensile secondo DIN 374		
	Gambo dell'utensile secondo DIN 376		
	Gambo dell'utensile secondo DIN 1835B / ISO 3338		
	Gambo dell'utensile secondo DIN 2174		
	Gambo dell'utensile secondo DIN 2181		
	Gambo dell'utensile secondo DIN 2182		
	Gambo dell'utensile secondo DIN 2183		
	Gambo dell'utensile secondo DIN 2189		
	Gambo dell'utensile secondo DIN 40432		
	Gambo dell'utensile secondo DIN 5156		
	Gambo dell'utensile secondo DIN 5157		

Icone	Materiale	Icone	Materiale
ALU	Alluminio	Acciaio INOX	Acciaio inossidabile Rm <= 1'200 N/mm ²
ALU Si <10%	Leghe di Alluminio Si < 10%	Acciaio HRC 42-53	Acciai temprati 45-53 HRC
ALU Si >10%	Leghe di Alluminio Si > 10%	Acciaio HRC 50-63	Acciai temprati 50-63 HRC
GG/G GHISA	Ghisa, Truciolo corto, Abrasivo	Ti	Titanio e leghe di titanio
CU	Rame, Leghe di Rame Truciolo Lungo <= 200 HB	OTTONE	Ottone
CU Tr.corto	Leghe di Rame Truciolo Corto		
CU 200-300 HB	Leghe di Rame 200 - 300 HB		
Ni	Nickel, Leghe di Nickel Rm <= 900 N/mm ²		
Ni 900-1500 N/mm ²	Leghe di Nickel 900 N/mm ² < Rm < 1'500 N/mm ²		
Acciaio ≤ 500 N/mm ²	Acciaio e acciaio fuso fino a 500 N/mm ²		
Acciaio 500-800 N/mm ²	Ghisa e acciai legati e non legati da 500 a 800 N/mm ²		
Acciaio 800-1200 N/mm ²	Acciai legati e temprati da 800 a 1200 N/mm ²		
Acciaio 800-1300 N/mm ²	acciaio per utensili, non legato, lavorato a freddo e resistente al calore		