

FRESE SEMISFERICHE

- RADIUSCHAFTFRÄSER
- BALL NOSE CUTTERS
- FRAISES À BOUT HÉMISFÉRIQUE
- FRESAS ESFÉRICAS



ILLI-CO HIGH QUALITY

HSS-Co8

ILLICO NORM*

EXTRA CORTA | EXTRA KURZ | EXTRA SHORT | EXTRA COURTE | EXTRA CORTA

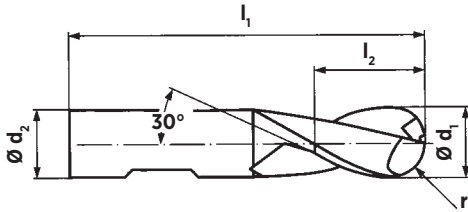
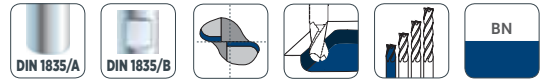

Ø d ₁ h ₁₀	r	l ₂	l ₁	Ø d ₂ h ₆	Z
----------------------------------	---	----------------	----------------	---------------------------------	---

2	1	4	48	6	2
3	1,5	5	49	6	2
4	2	7	51	6	2
5	2,5	8	52	6	2
6	3	8	52	6	2
7	3,5	10	60	10	2
8	4	11	61	10	2
9	4,5	11	61	10	2
10	5	13	63	10	2
11	5,5	13	70	12	2
12	6	16	73	12	2
13	6,5	16	73	12	2
14	7	16	73	12	2
15	7,5	16	73	12	2
16	8	19	79	16	2
18	9	19	79	16	2
20	10	22	88	20	2
22	11	22	88	20	2
24	12	26	102	25	2
25	12,5	26	102	25	2
26	13	26	102	25	2
28	14	26	102	25	2
30	15	26	102	25	2

4200	4200C	4201	4201C	4202
------	-------	------	-------	------

HSS-Co8	HSS-Co8 TICN	HSS-Co8	HSS-Co8 TICN	HSS-Co8
€ 28,50	€ 35,90	€ 28,50	€ 35,90	€ 31,30 ■
€ 28,50	€ 35,90	€ 28,50	€ 35,90	€ 31,30 ■
€ 28,50	€ 35,90	€ 28,50	€ 35,90	€ 31,30 ■
€ 28,50	€ 35,90	€ 28,50	€ 35,90	€ 31,30 ■
€ 32,55	€ 40,00	€ 32,55	€ 40,00	€ 35,40 ■
€ 41,30	€ 52,90	€ 41,30	€ 52,90	€ 43,60 ■
€ 36,65	€ 48,30	€ 36,65	€ 48,30	€ 39,20 ■
€ 43,00	€ 54,90	€ 43,00	€ 54,90	€ 45,20 ■
€ 38,85	€ 50,60	€ 38,85	€ 50,60	€ 41,30 ■
€ 54,90	€ 67,70	€ 54,90	€ 67,70	€ 57,00 ■
€ 50,00	€ 62,60	€ 50,10	€ 62,60	€ 51,70 ■
€ 61,50	€ 74,40	€ 61,50	€ 74,40	€ 63,40 ■
€ 59,80	€ 73,20	€ 59,80	€ 73,20	-
€ 67,70	€ 81,00	€ 67,70	€ 81,00	€ 69,40 ■
€ 67,70	€ 85,00	€ 67,70	€ 85,00	€ 69,90 ■
€ 73,80	€ 92,30	€ 73,80	€ 92,30	€ 75,80 ■
€ 74,90	€ 99,50	€ 74,90	€ 99,50	€ 78,40 ■
€ 112,50	€ 140,50	€ 112,50	€ 140,50	€ 114,00 ■
€ 134,00	€ 167,50	€ 134,00	€ 167,50	€ 134,00 ■
€ 132,50	€ 166,50	€ 132,50	€ 166,50	€ 133,00 ■
€ 171,00	€ 211,50	€ 171,00	€ 211,50	€ 164,50 ■
€ 171,00	€ 211,50	€ 171,00	€ 211,50	€ 164,50 ■
€ 174,00	€ 215,00	€ 174,00	€ 215,00	€ 167,50 ■

p. 220 p. 170



P	●●●	●●●	●●●	●●●	●●●
M	●○○	●●○	●○○	●●○	●○○
K	●●○	●●○	●●○	●●○	●●○
N	●○○	●○○	●○○	●○○	●○○
S	○○○	○○○	○○○	○○○	○○○
H	○○○	○○○	○○○	○○○	○○○

*Similare a DIN 327 | Ähnlich DIN 327 | Similar to DIN 327 | Similaire DIN 327 | Similar a DIN 327 **Articolo a richiesta | Auf Anfrage | On request | Sur demande | Bajo pedido

ASP-30

ILLICO NORM*



EXTRA CORTA | EXTRA KURZ | EXTRA SHORT | EXTRA COURTE | EXTRA CORTA

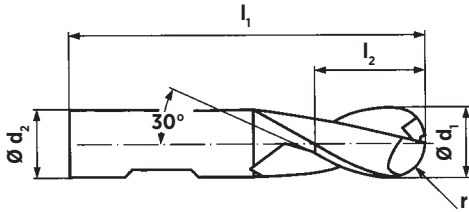

$\varnothing d_1 h_{10}$ r l_2 l_1 $\varnothing d_2 h_6$ Z

$\varnothing d_1 h_{10}$	r	l_2	l_1	$\varnothing d_2 h_6$	Z
2	1	4	48	6	2
3	1,5	5	49	6	2
4	2	7	51	6	2
5	2,5	8	52	6	2
6	3	8	52	6	2
7	3,5	10	60	10	2
8	4	11	61	10	2
9	4,5	11	61	10	2
10	5	13	63	12	2
11	5,5	13	70	12	2
12	6	16	73	12	2
13	6,5	16	73	12	2
14	7	16	73	12	2
15	7,5	16	73	12	2
16	8	19	79	16	2
18	9	19	79	16	2
20	10	22	88	20	2
22	11	22	88	20	2
24	12	26	102	25	2
25	12,5	26	102	25	2

4220 **4220C**

ASP-30

ASP-30
TiCN

ASP-30	ASP-30 TiCN
€ 33,40	€ 40,80
€ 33,40	€ 40,80
€ 33,40	€ 40,80
€ 33,40	€ 40,80
€ 38,35	€ 45,70
€ 48,30	€ 60,40
€ 43,00	€ 54,90
€ 50,60	€ 62,60
€ 45,70	€ 57,30
€ 64,80	€ 77,10
€ 58,70	€ 71,00
€ 77,80	€ 91,10
€ 75,50	€ 88,90
€ 85,50	€ 99,00
€ 85,50	€ 103,00
€ 92,80	€ 111,50
€ 95,00	€ 119,50
€ 142,00	€ 170,50
€ 169,50	€ 203,00
€ 168,50	€ 202,00



p. 220



p. 170

P
M
K
N
S
H

●●●	●●●
●●○	●●○
●●●	●●●
●○●	●○●
○●○	○●○
○●○	○●○

*Similare a DIN 327 | Ähnlich DIN 327 | Similar to DIN 327 | Similaire DIN 327 | Similar a DIN 327

HSS-Co8

ILLICO NORM

LUNGA | LANGE | LONG | LONGUE | LARGA

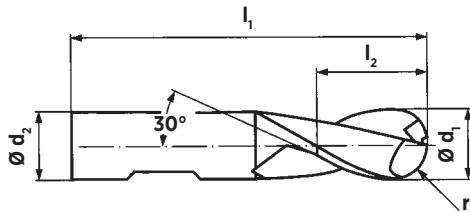

Ø d ₁ h ₁₀	r	l ₂	l ₁	Ø d ₂ h ₆	Z
----------------------------------	---	----------------	----------------	---------------------------------	---

3	1,5	8	56	6	2
4	2	11	63	6	2
5	2,5	13	68	6	2
6	3	13	68	6	2
7	3,5	16	80	10	2
8	4	19	88	10	2
9	4,5	22	88	10	2
10	5	22	95	10	2
11	5,5	26	102	12	2
12	6	26	110	12	2
13	6,5	26	110	12	2
14	7	26	110	12	2
15	7,5	26	110	12	2
16	8	32	123	16	2
18	9	32	123	16	2
20	10	38	141	20	2
22	11	38	141	20	2
24	12	45	166	25	2
25	12,5	45	166	25	2
30	15	45	166	25	2

4204	4204C	4206
------	-------	------

HSS-Co8	HSS-Co8 TiCN	HSS-Co8
---------	-----------------	---------

€ 35,90	€ 43,50	€ 38,50 ■
€ 35,45	€ 43,00	-
€ 35,45	€ 45,20	€ 38,10 ■
€ 35,45	€ 45,20	€ 38,10 ■
€ 45,90	€ 62,60	-
€ 42,50	€ 59,30	€ 44,70 ■
€ 49,10	€ 66,00	-
€ 45,90	€ 62,60	€ 48,00 ■
€ 61,00	€ 78,30	-
€ 59,30	€ 77,10	€ 60,80 ■
€ 69,30	€ 88,40	-
€ 64,80	€ 84,40	-
€ 73,20	€ 92,30	-
€ 72,70	€ 96,70	-
€ 93,90	€ 128,00	€ 95,20 ■
€ 95,60	€ 129,00	-
€ 119,50	€ 171,50	€ 121,50 ■
€ 145,00	€ 227,50	-
€ 141,00	€ 223,50	€ 141,00 ■
€ 226,00	€ 325,00	-



P	●●●	●●●	●●●
M	●○○	●○○	●○○
K	●●○	●●○	●●○
N	●○○	●○○	●○○
S	○○○	○○○	○○○
H	○○○	○○○	○○○

ASP-30

ILLICO NORM

LUNGA | LANGE | LONG | LONGUE | LARGA

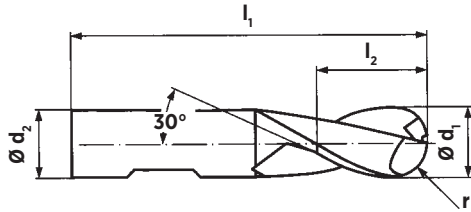

4224

4224C



	ASP-30	ASP-30 TiCN
	€ 42,20	€ 49,50
	€ 41,50	€ 49,10
	€ 41,50	€ 51,60
	€ 41,50	€ 51,60
	€ 53,90	€ 69,90
	€ 49,50	€ 66,50
	€ 57,80	€ 74,40
	€ 53,90	€ 69,90
	€ 71,00	€ 88,90
	€ 69,30	€ 87,20
	€ 87,20	€ 106,50
	-	€ 101,00
	€ 92,30	€ 111,50
	€ 91,70	€ 116,00
	€ 119,50	€ 152,00
	€ 120,50	€ 154,00
	€ 151,00	€ 203,00
	€ 183,50	€ 266,00
	€ 177,50	€ 260,00

$\varnothing d_1 h_{10}$	r	l_2	l_1	$\varnothing d_2 h_6$	Z
3	1,5	8	56	6	2
4	2	11	63	6	2
5	2,5	13	68	6	2
6	3	13	68	6	2
7	3,5	16	80	10	2
8	4	19	88	10	2
9	4,5	19	88	10	2
10	5	22	95	10	2
11	5,5	22	102	12	2
12	6	26	110	12	2
13	6,5	26	110	12	2
14	7	26	110	12	2
15	7,5	26	110	12	2
16	8	32	123	16	2
18	9	32	123	16	2
20	10	38	141	20	2
22	11	38	141	20	2
24	12	45	166	25	2
25	12,5	45	166	25	2



P	●●●	●●●
M	●●●	●●●
K	●●●	●●●
N	●●●	●●●
S	●●●	●●●
H	○●○	○●○

ASP-60

ILLICO NORM

EXTRA LUNGA | EXTRA LANGE | EXTRA LONG | EXTRA LONGUE | EXTRA LARGA

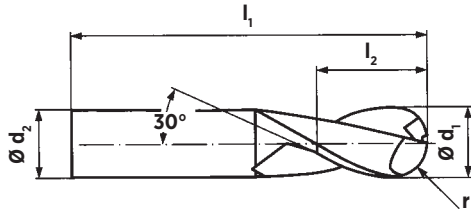

$\varnothing d_1 h_{10}$ r l_2 l_1 $\varnothing d_2 h_6$ Z

5	2,5	30	80	8	2
6	3	50	100	8	2
8	4	50	100	8	2
16	8	50	100	16	2
30	15	50	100	20	2

4439 **4439C**

ASP-60

ASP-60
TICN

€ 230,50	€ 276,60
€ 291,00	€ 349,20
€ 291,00	€ 349,20
€ 345,00	€ 414,00
€ 583,00	€ 699,60



P	●●●	●●●
M	●●○	●●○
K	●●●	●●●
N	●○●	●○●
S	●○●	●○●
H	○●○	○●○

ASP-60

ILICO NORM

EXTRA LUNGA TOP | TOP EXTRA LANGE | EXTRA LONG TOP | EXTRA LONGUE TOP | EXTRA LARGA TOP

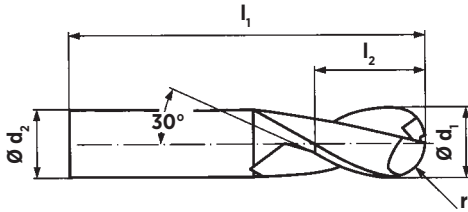

$\varnothing d_1 h_{10}$	r	l_2	l_1	$\varnothing d_2 h_6$	Z
--------------------------	---	-------	-------	-----------------------	---

4	2	30	130	8	2
5	2,5	30	130	8	2
6	3	50	150	8	2
8	4	50	150	8	2

4493 **4493C**



€ 345,00	■	€ 414,00	■
€ 359,00	■	€ 430,80	■
€ 499,00	■	€ 598,80	■
€ 499,00	■	€ 598,80	■



P
M
K
N
S
H

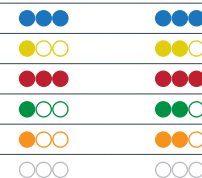

HSS-Co8

DIN 1889

CORTA | KURZ | SHORT | COURTE | CORTA

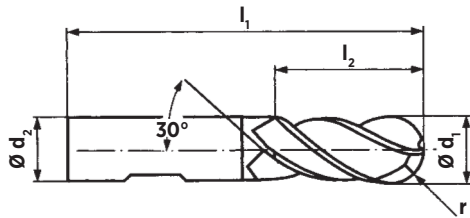

Ø d ₁ h ₁₀	r	l ₂	l ₁	Ø d ₂ h ₆	Z
----------------------------------	---	----------------	----------------	---------------------------------	---

6	3	13	57	6	4
8	4	19	69	10	4
10	5	22	72	10	4
12	6	26	83	12	4
16	8	32	92	16	4
20	10	38	104	20	4
25	12,5	45	121	25	5
32	16	53	133	32	6
40	20	63	155	40	6

4438 **4438C**

 HSS-Co8

 HSS-Co8
TiCN

€ 60,40	€ 67,70
€ 73,80	€ 85,50
€ 81,00	€ 92,80
€ 92,30	€ 105,00
€ 120,00	€ 140,50
€ 165,50	€ 190,50
€ 202,50	€ 239,00
€ 301,00	€ 348,00
€ 516,00	€ 617,00



P
M
K
N
S
H

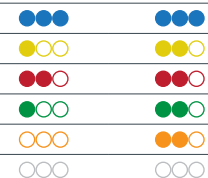

ASP-30

DIN 1889

CORTA | KURZ | SHORT | COURTE | CORTA

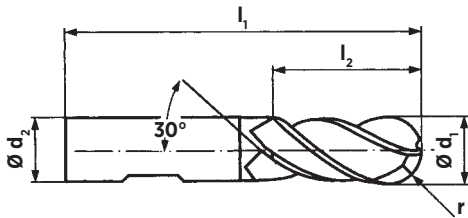

$\varnothing d_1 h_{10}$ r l_2 l_1 $\varnothing d_2 h_6$ Z

6	3	13	57	6	4
8	4	19	69	10	4
10	5	22	72	10	4
12	6	26	83	12	4
16	8	32	92	16	4
20	10	38	104	20	4
25	12,5	45	121	25	5
32	16	53	133	32	6
40	20	63	155	40	6



4488 **4488C**

ASP-30

ASP-30
TiCN

€ 69,90	€ 77,10
€ 85,50	€ 97,30
€ 93,90	€ 105,50
€ 107,00	€ 120,00
-	€ 170,50
€ 207,00	€ 232,00
€ 254,50	€ 292,00
€ 374,00	€ 423,00
€ 607,00	€ 709,00



P
M
K
N
S
H

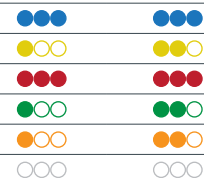

HSS-Co8

DIN 1889

LUNGA | LANGE | LONG | LONGUE | LARGA

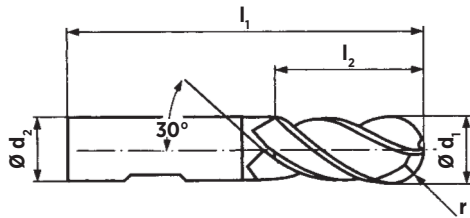

$\varnothing d_1 h_{10}$ r l_2 l_1 $\varnothing d_2 h_6$ Z

6 [▲]	3	24	68	6	4
8 [▲]	4	38	88	10	4
10	5	45	95	10	4
12	6	53	110	12	4
16	8	63	123	16	4
25	12,5	90	166	25	5
32	16	106	186	32	6
40	20	125	217	40	6

4442 4442C

HSS-Co8

HSS-Co8
TiCN

€ 66,50	€ 78,80
€ 80,00	€ 96,10
€ 88,90	€ 105,00
€ 101,50	€ 119,50
€ 140,50	€ 165,00
€ 269,00	€ 350,00
€ 389,00	€ 495,00
€ 607,00	€ 734,00



p. 220



p. 170

P
M
K
N
S
H



ASP-60

DIN 1889

EXTRA LUNGA | EXTRA LANGE | EXTRA LONG | EXTRA LONGUE | EXTRA LARGA

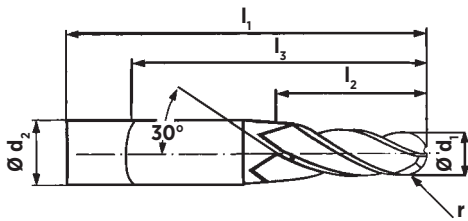

$\varnothing d_1 h_{10}$
 $\pm 0,02$ r l_2 l_3 l_1 $\varnothing d_2 h_6$ Z

$\varnothing d_1 h_{10}$ $\pm 0,02$	r	l_2	l_3	l_1	$\varnothing d_2 h_6$	Z
4	2	4,8	124	160	8	4
6	3	7,2	120	160	10	4
8	4	9,6	115	160	12	4
10	5	12	115	160	12	4
16	8	19,2	150	200	20	4



4495 **4495C**

ASP-60

ASP-60
TiCN

€ 93,10	€ 106,50
€ 106,00	€ 124,00
€ 119,00	€ 142,00
-	€ 152,68 ■
€ 204,00	€ 248,00



p. 220



p. 170

P
M
K
N
S
H

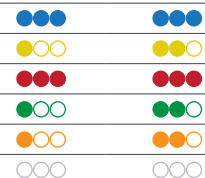

HSS-Co8

DIN 1889D

CORTA | KURZ | SHORT | COURTE | CORTA

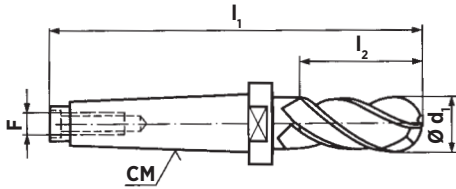

4446 **4446C**

 HSS-Co8

 HSS-Co8
TiCN

€ 147,00 ■	€ 163,00 ■
€ 160,00 ■	€ 177,00 ■
€ 210,00 ■	€ 234,00 ■
€ 253,00 ■	€ 286,00 ■
€ 353,00 ■	€ 441,25 ■
€ 481,00 ■	€ 602,00 ■

$\varnothing d_1, h_{10}$ l_2 l_1 CM F Z

10	22	92	1	M6	4
12	26	96	1	M6	4
16	32	117	2	M 10	4
20	38	123	2	M 10	4
25	45	147	3	M 12	6
32*	53	201	4	M 16	6



p. 220



p. 170

P
M
K
N
S
H

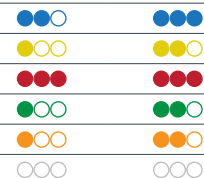

*Attacco cono Morse secondo DIN 2207 | Morsekegel nach DIN 2207 | Morse taper shank according to DIN 2207 | Queue cône Morse suivant DIN 2207 | Mango cónico según DIN 2207

HSS-Co8

DIN 1889D

LUNGA | LANGE | LONG | LONGUE | LARGA

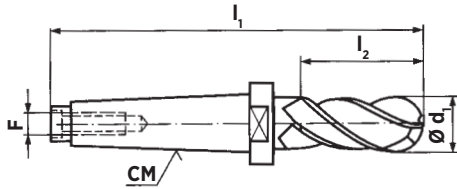

$\varnothing d_1, h_{10}$	l_2	l_1	CM	F	Z
---------------------------	-------	-------	----	---	---

10	45	115	1	M6	4
12	53	123	1	M6	4
16	63	148	2	M10	4
20	75	160	2	M10	4
25	90	192	3	M12	6







	4448	4448C
--	------	-------

 HSS-Co8

 HSS-Co8
TiCN

€ 170,00	■	€ 191,50	■
€ 179,00	■	€ 202,50	■
€ 249,00	■	€ 276,00	■
-		€ 338,00	■
€ 446,00	■	€ 532,00	■

 p. 220  p. 170

P		
M		
K		
N		
S		
H		

HSS-Co8

DIN 1889

CORTA | KURZ | SHORT | COURTE | CORTA

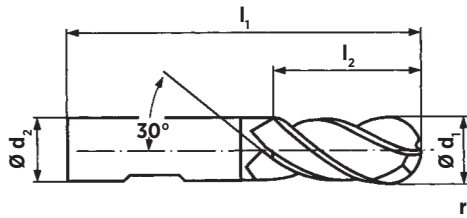

$\varnothing d_1 h_{10}$	l_2	l_1	$\varnothing d_2 h_6$	Z
--------------------------	-------	-------	-----------------------	---

6	13	57	6	4
8	19	69	10	4
10	22	72	10	4
12	26	83	12	4
16	32	92	16	4
20	38	104	20	4
25	45	121	25	4
32	53	133	32	6
40	63	155	40	6

7426	7426C
------	-------



€ 74,90	€ 82,20
€ 85,50	€ 97,30
€ 86,00	€ 97,80
€ 102,50	€ 115,00
€ 138,50	€ 159,00
€ 175,00	€ 199,00
€ 224,50	€ 263,00
€ 327,00	€ 373,00
€ 516,00	€ 622,00

p. 220 p. 171

P
M
K
N
S
H

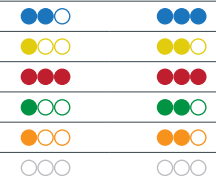

E-COMMERCE



Angelo Ghezzi & C SpA



ORDINI ONLINE | ONLINE ORDERS

www.angeloghezzi.it

ASP-30

DIN 1889

CORTA | KURZ | SHORT | COURTE | CORTA

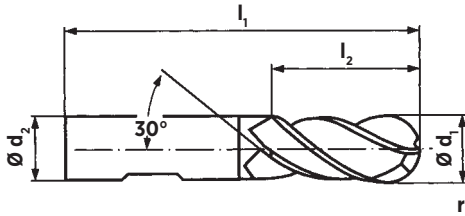

$\varnothing d_1 h_{10}$	l_2	l_1	$\varnothing d_2 h_6$	Z
--------------------------	-------	-------	-----------------------	---

6	13	57	6	4
8	19	69	10	4
10	22	72	10	4
12	26	83	12	4
16	32	92	16	4
20	38	104	20	4
25	45	121	25	4
32	53	133	32	6

7476

7476C



€ 112,50

€ 114,00

€ 130,00

€ 132,00

€ 132,50

€ 134,50

€ 157,00

€ 159,50

€ 220,50

€ 226,50

€ 285,00

€ 286,00

€ 375,00

€ 389,00

€ 552,00

€ 563,00



p. 220



p. 171

P
M
K
N
S
H



HSS-Co8

DIN 1889

LUNGA | LANGE | LONG | LONGUE | LARGA

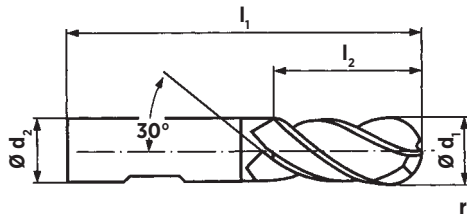

$\varnothing d_1 h_{10}$	l_2	l_1	$\varnothing d_2 h_6$	Z
--------------------------	-------	-------	-----------------------	---

6 [▲]	24	68	6	4
8 [▲]	38	88	10	4
10	45	95	10	4
12	53	110	12	4
16	63	123	16	4
20	75	141	20	4
25	90	166	25	4
32	106	186	32	6
40	125	217	40	6

7430	7430C
------	-------



€ 90,60	€ 102,50
€ 104,00	€ 121,00
€ 117,50	€ 133,50
€ 138,50	€ 156,00
€ 188,50	€ 214,00
€ 236,00	€ 271,00
€ 332,00	€ 413,00
€ 491,00	€ 597,00
€ 807,00	€ 927,00



P
M
K
N
S
H



ASP-60

DIN 1889

CORTA | KURZ | SHORT | COURTE | CORTA



HARD STEEL

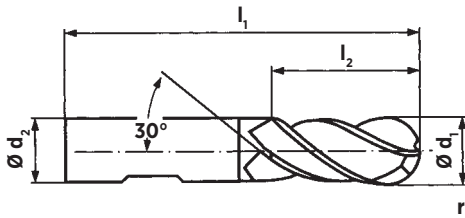

Ø d ₁	l ₂	l ₁	Ø d ₂ h ₆	Z
6	13	57	6	4
8	19	69	10	4
10	22	72	10	4
12	26	83	12	4
16	32	92	16	4
20	38	104	20	5
25	45	121	25	5
32	53	133	32	6

7427	7427C	7429	7429C
€ 112,50	€ 114,00	€ 112,50	€ 114,00
€ 130,00	€ 132,00	€ 130,00	€ 132,00
€ 132,50	€ 134,50	€ 132,50	€ 134,50
€ 157,00	€ 159,50	€ 157,00	€ 159,50
€ 220,50	€ 226,50	€ 220,50	€ 286,00
€ 285,00	€ 286,00	€ 285,00	€ 286,00
€ 375,00	€ 389,00	€ 386,00	€ 389,00
€ 552,00	€ 563,00	€ 561,00	€ 569,00



p. 220



p. 171

P	●●●●	●●●●	●●●●	●●●●
M	●●●●	●●●●	●●●●	●●●●
K	●●●●	●●●●	●●●●	●●●●
N	●●●●	●●●●	●●●●	●●●●
S	●●●●	●●●●	●●●●	●●●●
H	○●○●	○●○●	○●○●	○●○●

ASP-30

DIN 1889

LUNGA | LANGE | LONG | LONGUE | LARGA

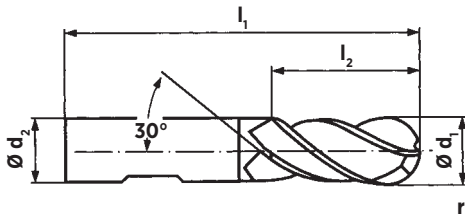

$\varnothing d_1 h_{10}$	l_2	l_1	$\varnothing d_2 h_6$	Z
--------------------------	-------	-------	-----------------------	---

6 [▲]	24	68	6	4
8 [▲]	38	88	10	4
10	45	95	10	4
12	53	110	12	4
16	63	123	16	4
20	75	141	20	4
25	90	166	25	5
32	106	186	32	6
40	125	217	40	6

	7480	7480C
--	------	-------



	€ 98,30	€ 111,00
	€ 113,50	€ 130,00
	€ 128,50	€ 144,50
	€ 151,00	€ 168,50
	€ 206,00	€ 229,50
	€ 258,50	€ 292,00
	€ 368,00	€ 449,00
	€ 539,00	€ 646,00
	€ 884,00	€ 1.010,00



P
M
K
N
S
H

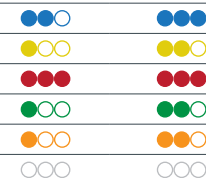

HSS-Co8

DIN 1889D

CORTA | KURZ | SHORT | COURTE | CORTA

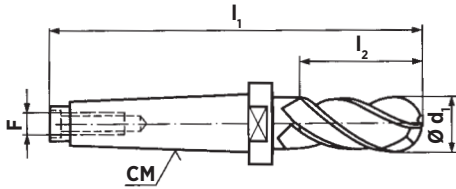

Ø d ₁	l ₂	l ₁	CM	F	Z
10	22	92	1	M6	4
12	26	96	1	M6	4
16	32	117	2	M10	4
20	38	123	2	M10	4
25	45	147	3	M12	5
32*	53	201	4	M16	6

	7434	7434C
	€ 188,00	€ 204,00
	€ 204,00	€ 221,50
	€ 266,00	€ 291,00
	€ 312,00	€ 345,00
	€ 425,00	€ 506,00
	€ 574,00	€ 700,00



P		
M		
K		
N		
S		
H		

*Attacco cono Morse secondo DIN 2207 | Morsekegel nach DIN 2207 | Morse taper shank according to DIN 2207 | Queue cône Morse suivant DIN 2207 | Mango cónico según DIN 2207

HSS-Co8

DIN 1889D

LUNGA | LANGE | LONG | LONGUE | LARGA

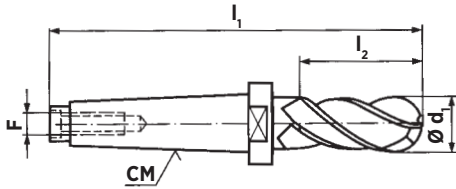

$\emptyset d_1$	l_2	l_1	CM	F	Z
10	45	115	1	M6	4
12	53	123	1	M6	4
16	63	148	2	M10	4
20	75	160	2	M10	4
25	90	192	3	M12	5
32*	106	254	4	M16	6
40*	125	273	4	M16	6

	7436	7436C
	€ 228,00	€ 252,50
	€ 269,00	€ 293,00
	€ 322,00	€ 350,00
	€ 384,00	€ 420,00
	€ 545,00	€ 636,00
	€ 772,00	€ 884,00
	€ 1.141,00	€ 1.276,00



P		
M		
K		
N		
S		
H		

*Attacco cono Morse secondo DIN 2207 | Morsekegel nach DIN 2207 | Morse taper shank according to DIN 2207 | Queue cône Morse suivant DIN 2207 | Mango cónico según DIN 2207

TIPO BN | TYPE BN

f_z [mm] AVANZAMENTO AL DENTE | f_z [mm] TOOTH FOR FEED

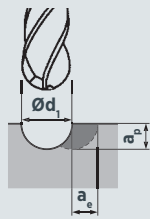

$$a_p = 0,5 \times d_1 \text{ mm}$$

$$a_e = 0,5 \times d_1 \text{ mm}$$

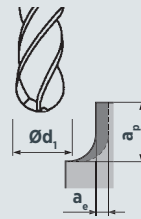

$$a_p = 1 \times d_1 \text{ mm}$$

Ø	CONTORNATURA SIDE MILLING		
	CAVA f_z SLOTTING f_z	SEMI FINITURA f_z SEMI FINISHING f_z	$a_e = 0,25 \times d_1 \text{ mm}$
2	0,007	0,012	0,50
3	0,011	0,018	0,75
4	0,014	0,024	1,00
5	0,018	0,030	1,25
6	0,022	0,036	1,50
8	0,029	0,048	2,00
10	0,036	0,060	2,50
12	0,043	0,072	3,00
14	0,050	0,084	3,50
16	0,058	0,096	4,00
18	0,065	0,108	4,50
20	0,072	0,120	5,00
22	0,079	0,132	5,50
25	0,090	0,150	6,25
28	0,101	0,168	7,00
32	0,115	0,192	8,00
36	0,130	0,216	9,00
40	0,144	0,240	10,00

V_c [m/min] VELOCITÀ DI TAGLIO | V_c [m/min] CUTTING SPEED

		P ₁	P ₂	P ₃	M ₁	M ₂	K ₁	K ₂	N ₁	N ₂	S ₁	S ₂	H
V_c [m/min] RIVESTITO COATED	Min	25	20	15	10	8	15	20	40	35	10	-	-
	Max	50	40	25	15	12	35	25	90	80	15	-	-
V_c [m/min] NON RIVESTITO UNCOATED	Min	20	15	10	7	5	15	10	35	25	8	-	-
	Max	35	30	15	10	8	25	20	60	55	10	-	-
* COEFFICIENTE AVANZAMENTO		1	0,8	0,6	0,6	0,4	1	0,7	1,8	1	0,4	0,6	0,4
* FEED COEFFICIENT													

* Moltiplicare l'avanzamento " f_z " relativo al diametro x il coefficiente avanzamento relativo al materiale.
Esempio: fresa Ø 16 (cava) " f_z " 0,058 materiale gruppo P₃ - 0,058x0,6 = 0,035 " f_z "

* Multiply the feed " f_z " of the diameter by the feed coefficient of the related material.
Example: Endmill Ø 16 (slotting) " f_z " 0,058 material group P₃ - 0,058x0,6 = 0,035 " f_z "



TIPO BNR | TYPE BNR

f_z [mm] AVANZAMENTO AL DENTE | f_z [mm] TOOTH FOR FEED

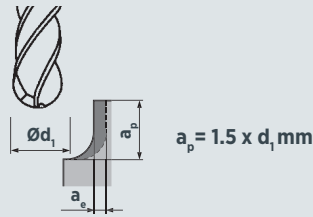

CONTORNATURA SIDE MILLING		
Ø	SGROSSATURA f_z ROUGHING f_z	$a_e = 0.1 \times d_1$ mm
5	0,021	0,50
6	0,025	0,60
8	0,034	0,80
10	0,042	1,00
12	0,050	1,20
14	0,059	1,40
16	0,067	1,60
18	0,076	1,80
20	0,084	2,00
22	0,092	2,20
25	0,105	2,50
28	0,118	2,80
32	0,134	3,20
36	0,151	3,60
40	0,168	4,00

V_c [m/min] VELOCITÀ DI TAGLIO | V_c [m/min] CUTTING SPEED

		P ₁	P ₂	P ₃	M ₁	M ₂	K ₁	K ₂	N ₁	N ₂	S ₁	S ₂	H
V_c [m/min] RIVESTITO COATED	Min	30	25	10	15	10	25	10	-	50	15	-	-
	Max	60	50	20	30	20	50	20	-	70	25	-	-
V_c [m/min] NON RIVESTITO UNCOATED	Min	25	20	7	10	7	20	7	-	30	7	-	-
	Max	40	30	15	25	15	30	15	-	50	17	-	-
* COEFFICIENTE AVANZAMENTO * FEED COEFFICIENT		1	0,8	0,6	0,6	0,4	1	0,7	1,8	1	0,4	0,6	0,4

* Moltiplicare l'avanzamento " f_z " relativo al diametro x il coefficiente avanzamento relativo al materiale.
Esempio: fresa Ø 16 (sgrossatura) " f_z " 0,067 materiale gruppo M₁ - $0,067 \times 0,6 = 0,04$ " f_z "

* Multiply the feed " f_z " of the diameter by the feed coefficient of the related material.
Example: Endmill Ø 16 (roughing) " f_z " 0,067 material group M₁ - $0,067 \times 0,6 = 0,04$ " f_z "

